

# WS-M Stainless steel weather shield adaptable to ...Max actuators size M

Subject to change!

Type	Description
WS-M	Stainless steel weather shield for ...Max... size M

## Product views and applications

WS-M

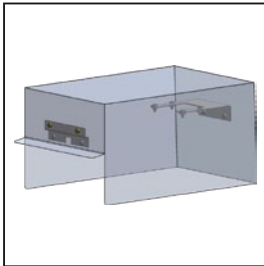

WS-M with ...Max size M

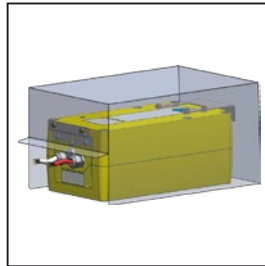

WS-M with ...Max-A size M

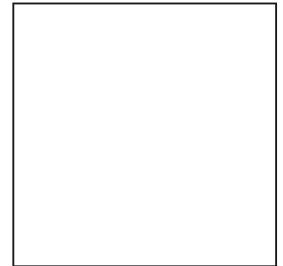
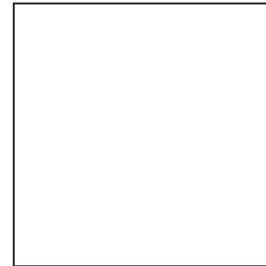
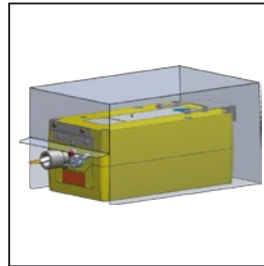

## Mounting

1. Mount front bracket
2. Mount rear bracket
3. Put weather shield over the actuator
4. Fix screws

### Important Notes

Avoid direct sunlight!  
The maximum permissible ambient temperature may be exceeded.

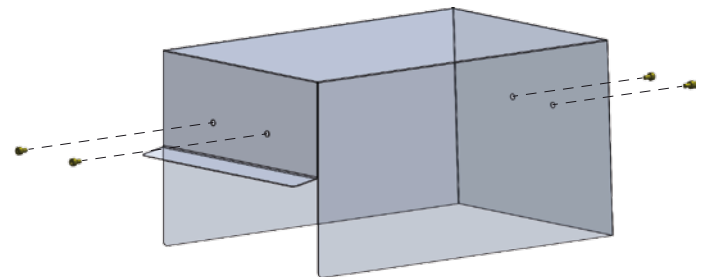

## Technical data

Housing material	V4A / AISI 316L / DIN EN 1.4404
Bracket	V4A / AISI 316L / DIN EN 1.4404
Screws	V4A / AISI 316L
Dimensions	L x W x H = 322 x 202 x 167 mm
Weight	~ 1.6 kg
Delivery	Weather shield, brackets, screws

