



Ex-e terminal box – for ExMax actuators S and M

Type	Description	Details	Installation area
ExBox-3P	Ex-e terminal box for ExMax-.. actuators	On-off and 3 pos, with and without spring return	Zone 1, 2, 21, 22
ExBox-Y/S	Ex-e terminal box for ExMax-...S.. actuators	like before with internal aux. switches	Zone 1, 2, 21, 22
	Ex-e terminal box for ExMax-...Y actuators	continuous control with and without spring return	Zone 1, 2, 21, 22
ExBox-BF	Ex-e terminal box for ExMax-...BF actuators		Zone 1, 2, 21, 22
ExBox-SW	Ex-e terminal box for ExSwitch	external aux. switches	Zone 1, 2, 21, 22

Varianten

ExBox-...



Abmessungen

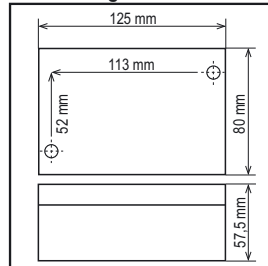

ExBox-3P

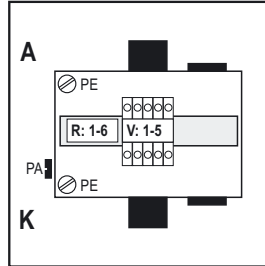

ExBox-Y/S

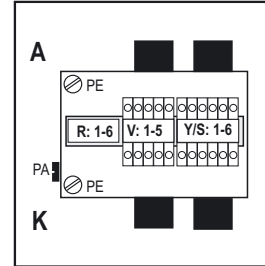

ExBox-BF

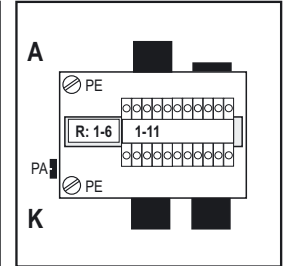

- K = Cable coming from customer site
- A = Cable coming from actuator
- V = Terminals for supply, on-off and 3-pos control mode
- Y = Terminals for continuous control input and feedback signals Y and U
- S = Terminals for actuators with internal aux. switches (ExMax-...-S..)
- R = Margin space for terminals of external aux. switch type ExSwitch

ExBox-SW

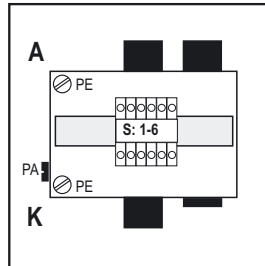

MKK-S

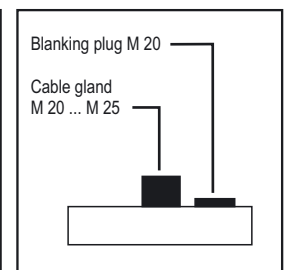

Description

ExMax actuators are delivered with 1 m cable. In case of cable connection inside hazardous areas a certificated Ex-e terminal box is required. Terminal boxes type ExBox are special designed for ExMax actuators for installation in hazardous areas zone 1, 2, 21 and 22.

Attention

Before an Ex-e terminal box may be opened the supply voltage of the wiring must be cut, otherwise the requirements for use and maintenance in hazardous areas is not full filled.

Margin space for ExSwitch (adaptable, external aux. switches)

Terminal boxes have enough space for additional cable glands and terminals to connect two external aux. switches. The accessory **Kit-1** includes all needed components for the terminal box. This terminal box must be ordered with the option .../SW. Special terminal boxes on request.

Explosion proof

PTB-tested	PTB 05 ATEX 1001, in acc. with RL 94/9/EG (ATEX)
For zone 1, 2, 21, 22	II2G/2D EEx e II T6 for gas, mist, vapour, dust
IP protection	IP 66 in acc. with EN 60529
Potential compensation	external PA-terminal, max. 4 mm ²

Accessories

Kit-1 (for ExSwitch)	1 × M 25 duplex + 6 Ex-e terminals 1,5 mm ²
ExBox-3P/SW	for actuator + ExSwitch same ExBox-3P + 1 × M20+Kit
ExBox-Y/S/SW	for Y-actuator + ExSwitch same ExBox-Y/S + 1 × M20+Kit
ExBox-BF/SW	for BF-actuator + ExSwitch same ExBox-BF + 1 × M20+Kit
MKK-S or MKK-M	mounting bracket to adapt ExBox to ExMax stainless steel
.../CT	Amercoat painting + cable glands in Ms. nickel-plated

Technical data

Type	ExBox-3P	ExBox-Y/S	ExBox-BF
For actuators	ExMax-5.10 ExMax -15.30 ExMax-50.75 ExMax-100 ExMax -5.10-F ExMax-15-F ExMax-30-F ExMax-50-F ExMax-...-R	ExMax-5.10-S ExMax-15.30-S ExMax-5.10-Y ExMax-15.30-Y ExMax-50.75-S ExMax-100-S ExMax-50.75-Y ExMax-100-Y ExMax-5.10-SF ExMax-15-SF ExMax-5.10-YF ExMax-15-YF ExMax-30-SF ExMax-50-SF ExMax-30-YF ExMax-50-YF	ExMax -5.10-BF ExMax-15-BF ExMax-30-BF ExMax-50-BF
Cable glands site K	1 × M 20 (Ø 6 - 13 mm)	2 × M 20 (Ø 6 - 13 mm) 2 × M 20 (Ø 6 - 13 mm)	
Cable glands site A	1 × M 20 (Ø 6 - 13 mm)	2 × M 20 (Ø 6 - 13 mm) 1 × M 20 (Ø 6 - 13 mm)	
Terminals V	5 × 4 mm ²	5 × 4 mm ²	5 × 4 mm ²
Terminals Y/S	–	6 × 4 mm ²	6 × 4 mm ²
PE-connection	2 × 4 mm ²	2 × 4 mm ²	2 × 4 mm ²
Temperature range	Ambient temperature -40...+60°C		
Box data	aluminium coated, weight ~ 750g, dimension L × W × H = 125 × 80 × 57 mm		